

SADDLE RANCH BUSINESS CENTER - FOR SALE OR LEASE

3300 HORSELESS CARRIAGE DRIVE, BUILDING 2 | NORCO, CA 92860
±95,122 SF | STATE OF THE ART INLAND EMPIRE INDUSTRIAL FACILITY

Another Quality Project by:

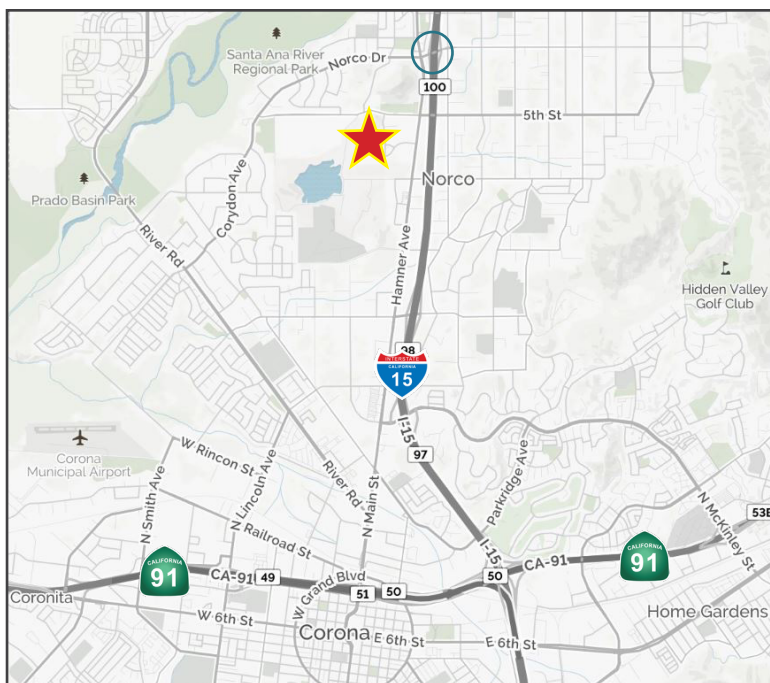

AVAILABLE SF:	±95,122 SF
OFFICE SF:	±5,881 SF (2-Story)
CEILING HEIGHT:	30' Clear
DOCK HIGH DOORS:	8 (9'X10')
GROUND LEVEL DOORS:	1 (12'X14')
SPRINKLER SYSTEM:	ESFR
POWER:	2,000 AMPS; 277/480V
NATURAL GAS LINE:	Stubbed to Building
YARD:	No
PARKING RATIO:	1.4/1,000
COMMENTS:	Easy Access to I-15 Freeway, Painted Warehouse Walls with White Scrim on the Ceiling

LEE & ASSOCIATES COMMERCIAL REAL ESTATE SERVICES, INC. - RIVERSIDE

JEFF RUSCIGNO, SIOR	951.276.3630	DRE #01030286	jruscigno@leeriverside.com
PAUL EARNHART, SIOR	909.989.7771	DRE #00822072	pearhart@ee-assoc.com
BRIAN PHARRIS	909.373.2927	DRE #01329363	bpharris@lee-assoc.com
RYAN EARNHART	909.373.2724	DRE #01426559	rearnhart@lee-assoc.com



SADDLE RANCH BUSINESS CENTER - FOR SALE OR LEASE

Another Quality Project by:



3300 HORSELESS CARRIAGE DRIVE, BUILDING 2 | NORCO, CA 92860

±95,122 SF | STATE OF THE ART INLAND EMPIRE INDUSTRIAL FACILITY

Floor Plan Building 2

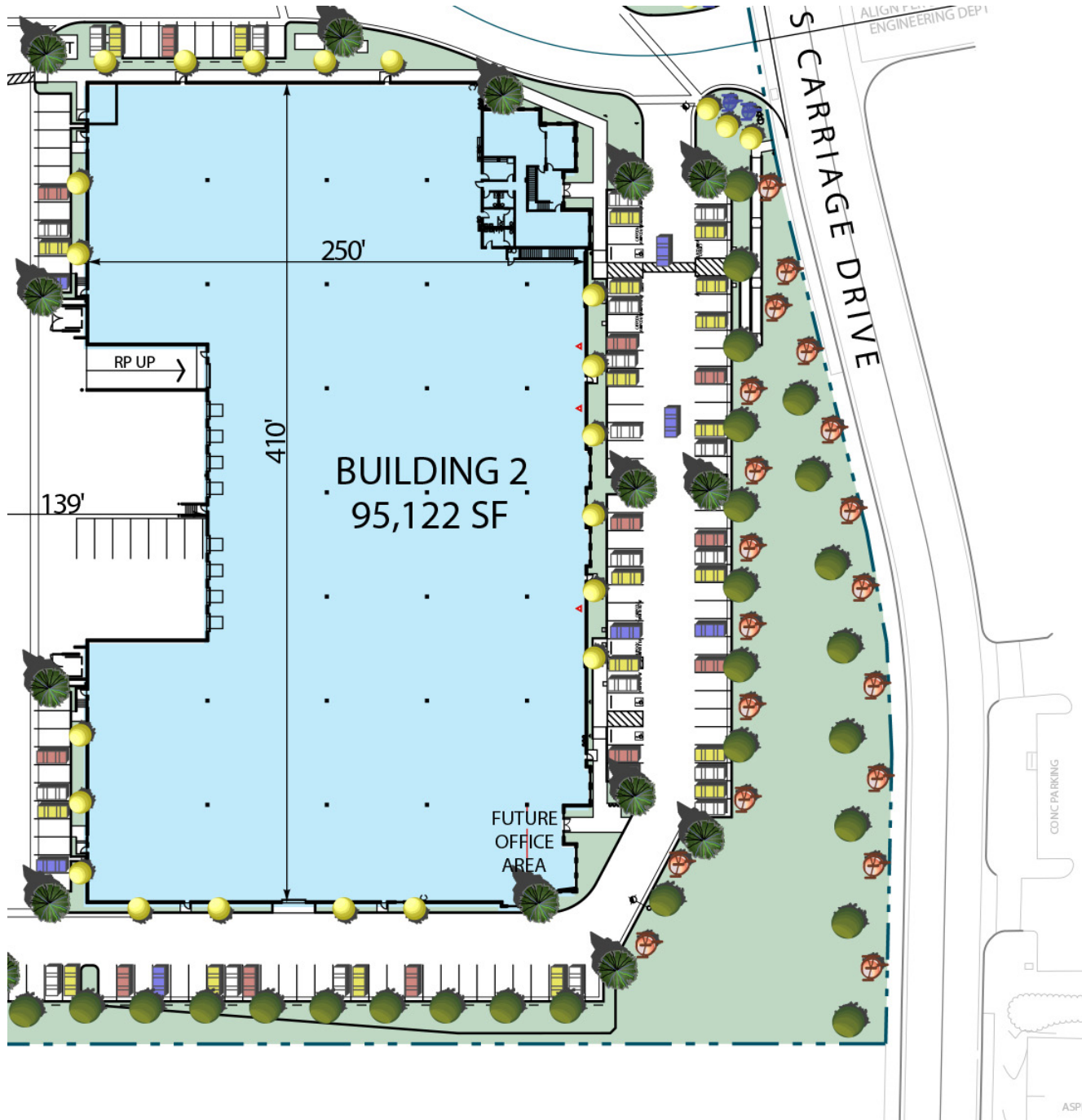

LEE & ASSOCIATES COMMERCIAL REAL ESTATE SERVICES, INC. - RIVERSIDE

JEFF RUSCIGNO, SIOR

951.276.3630 DRE #01030286

jruscigno@leeriverside.com

PAUL EARNHART, SIOR

909.989.7771 DRE #00822072

pearnhart@ee-assoc.com

BRIAN PHARRIS

909.373.2927 DRE #01329363

bpharris@lee-assoc.com

RYAN EARNHART

909.373.2724 DRE #01426559

rearnhart@lee-assoc.com

